

DIRECTIONS TO THE FIELD:

Directions to the field: Watch for Coursing signs to the field. The field is visible from Rt. 15. Located in front of the Plantation Mansion, and on the Main Entrance Road. The main gate on Plantation Drive is open 9-5. Coursing exhibitors must use Gap road (a narrow road Before the Plantation entrance), then Turn right and follow the Gravel road to the field.

Directions from the North:

From Interstate 70 in Frederick, MD: take Route 340/15 South. Bear onto 15S at the split. Leesburg is 24 miles. Follow 15/7 Leesburg bypass to 15 South Oatlands is 6 miles south of Leesburg on Rt. 15. Turn LEFT on to **Gap Road** and proceed to the field on the right. **Gap Rd.** is BEFORE Oatlands this direction. Watch for coursing signs.

From Washington Beltway: take either Route 7 or Dulles Greenway west to Leesburg 15/7 bypass, then exit south on Route 15-South. Follow rest of directions above.

Directions from the South:

Follow Route 15 North toward Leesburg. Oatlands is on the right before Leesburg. Go past the main entrance of Oatlands and TURN RIGHT on the first road, **Gap Road**. This is a narrow dirt road. Follow coursing signs to the field.

VETERINARY CARE

TLC Emergency Clinic, 165 Ft.Evans Rd. N.E., Leesburg, VA 5; 703-777-5755. (Rt 15 bypass to Rt.7Bus.; R. on Ft. Evans to end)

Blue Ridge Veterinary Assoc.: 120 E. Cornwell Ln., Purcellville, VA; From the Rt. 7-15 bypass (& W.Market St.), go west on Rt. 7 for 6.5 miles. Take the Purcellville exit (Rt. 287) toward Purcellville and Business 7, Take immediate right onto Hirst Rd. Go approx. 1 mile & take a left onto Hatcher Ave. Take the next right onto E. Skyline Dr. to the clinic.) They are also a 24-hr. emergency service.

EARLY ENTRIES CLOSE 6 pm ON WEDNESDAY, October 24,2018
At 3620 Cemetery Lane Westminster, MD 21158
DAY-OF-TRIAL ENTRIES CLOSE 15 MINUTES BEFORE ROLL CALL
at the Field Trial Secretary's table each day

POTOMAC AFGHAN HOUND CLUB And DISTRICT AREA SIGHTHOUND CLUB HOST

ASFA ALL-BREED REGION 8 REGIONAL INVITATIONAL

OCTOBER 27 & 28, 2018



Oatlands Plantation
20850 Oatlands Plantation Lane
Leesburg, Virginia



EARLY ENTRIES: \$20.00 for the FIRST HOUND
\$18.00 for each additional entry
Day of trial entry \$25.00 PER HOUND
Breeder/Kennel Stake: \$5 per pair
Bench Stake: \$5 each hound
TRIAL Hours: 7:30 am until complete
ROLL CALL: 8:30 am ALL BREEDS
(CELL ON FIELD: 301-938-4558)

Regional Invitational Requirements:

Any hound that is ASFA pointed or is pointed in its country of residence or is AKC pointed, is eligible to enter a Regional Invitational in an appropriate stake, including Single Stake, if offered. Proof of non-ASFA points for hounds should be in the form of a photocopy of the certificate, or a page of formal printing, included with the entry. For a Limited breed to be eligible, the entry must have one first placement, or two second placement, with competition in the Limited Stake. For a Provisional breed to be eligible, the hound must have received a placement with competition. All points or placements must be earned by the closing date of the event. An eligible hound may be entered in any number of Regional Invitationals. Hounds entered in the Single Stake are not eligible to be entered in Breeder, Kennel, or Bench stakes. Permission has been granted by the American Sighthound Field Association for this event under American Sighthound Field Association Rules and Regulations. Audrey Silverstein, Chair ASFA Scheduling Committee

Go to www.ASFA.org for online Rulebook, Policies, Contacts, Clubs, Trial Schedules, Trial Results & much more.

Potomac Afghan Hound Club

OFFICERS: President- Karen Wagner, VP—Jay Johnson
 Secretary- Ann Nicholson, Linda Jordan Treasurer, Board Members: Ken Hudson Jay Johnson, Neva Johnson, Kitty Davis, Bob Jordan

District Area Sighthound Association Club

OFFICERS: President: Bob Jordan, Secretary/Treasurer Linda, Jordan
 Kitty Davis, Beth Ann Haner

American Sighthound Field Association

Officers and Directors: **President**, Dean Wright – **President**
 1st Vice President Phil Fullam; 2nd Vice President Gregory Breibach:
Corresponding Secretary Holly Hamilton; **Recording Secretary**; Ping Pirrung; **Chief Financial Officer**: Gary Roush; **Region Directors- Region 1**
 Karen Sanders; **Region 2** ;open; **Region 3**: Dan Heidel; **Region 4**: Gary Runyan;
Region 5: Kent Sandeford; **Region 6**: Lee Warden; **Region 7**: Elaine McMichael; **Region 8**: Kathy Sanders;
Region 9: Ben Brodeur; **Region 10**: Lori Silvestri

JUDGES AND ASSIGNMENTS:

John Arvin: Barnegat NJ
Francis Byrne: Clear Spring, MD.
James Dumais: Littlestown PA.
Donna Richards: Denver NC
Dean Wright: Hanover, PA.

Saturday Assignments																		
	A F	A Z	B A	B Z	C I	G H	I B	I G	I W	P H	R R	S A	S D	S L	S W	W H	L T D	S G L
D W	X	X		X	X	X			X			X	X					X
D R	X	X			X	X			X			X	X					X
F B			X				X	X		X	X			X	X	X	X	
J D			X	X			X	X		X	X			X	X	X	X	

Sunday Assignments																		
	A F	A Z	B A	B Z	C I	G H	I B	I G	I W	P H	R R	S A	S D	S L	S W	W H	L T D	S G L
D W			X				X	X		X	X				X	X	X	
D R			X	X			X	X		X	X				X		X	
F B	X	X			X	X			X			X	X	X				X
J A	X	X		X	X	X			X			X	X	X		X		X

FIELD COMMITTEE:

Field Trial Chairman: Bob Jordan (301) 938-4558
 Field Trial Secretary: Audrey Silverstein, 3620 Cemetery Ln,
 dinosmommie@yahoo.com
 Westminster, MD 21158 Telephone: (410) 868-6369
 Lure Operators: Jay Johnson, Bob Jordan, Harry Van Vliet, Francis Byrne

ELIGIBLE BREEDS AND REGISTRY

Only purebred Afghan Hounds, Azawakhs, Basenjis, Borzois, Cirnechi dell'Etna, Greyhounds, Ibizan Hounds, Irish Wolfhounds, Italian Greyhounds, Pharaoh Hounds, Rhodesian Ridgebacks, Salukis, Scottish Deerhounds, Silken Windhounds, Sloughis, and Whippets may be entered in the regular stakes.

Limited breeds may be entered in the Limited Stake or the Singles Stake. Limited stake breeds currently include: purebred Chart Polskis, Galgo Españols, Magyar Agars, Peruvian Inca Orchids, & Portuguese Podengos (Medio, Grande & Pequeno) and must be individually registered with the appropriate registry. All entries shall be individually registered with the AKC (ILP/PAL included), the NGA, the UKC, the FCI, an ASFA-recognized foreign or ASFA Board approved registry, or possess a CRN from the SPDBS. A photocopy of acceptable registry must be submitted with each hound's first ASFA field trial entry, this requirement is waived for hounds registered with the NGA.

REGULAR STAKES OFFERED

- OPEN STAKE:** Any eligible Sighthound that has met certification requirements excluding ASFA Field Champions of record.
- FIELD CHAMPION STAKE:** Any ASFA Field Champion.
- VETERAN STAKE:** Any eligible Sighthound that has met certification requirements and is 6 years of age or older (5 years for Irish Wolfhounds; 7 years for Afghans, Saluki, Rhodesian Ridgebacks, and Whippets).
- SINGLES STAKE:** Any eligible Sighthound including those disqualified to run in other stakes. Not eligible for Best of Breed or Best in Field. Hounds are eligible to earn TCP and CPX titles from the Singles stake. Limited breeds are not eligible for these titles. Each hound runs alone.
- LIMITED STAKE:** Any eligible Sighthound of a Limited breed that has met certification requirements. Not eligible to compete in Best of Breed or Best in Field.

NON-REGULAR STAKES OFFERED

- KENNEL STAKE:** For hounds of any individual breeds; an entry shall consist of two hounds, designated at time of entry, in one of the regular stakes being owned and kenneled by the same person.
- BREEDER STAKE:** For any eligible breed which shall have, designated at time of entry, two hounds bred by the same individual.
- BENCH STAKE:** For any eligible sighthound with proof on file with the ASFA of Conformation champion title from the AKC, CKC or both, or a conformation grand champion title from the UKC.
- BEST SINGLE IN EVENT:** Top Single, Saturday * Sunday May compete in single runs on Sunday for Best Single in Event
- BEST IN FIELD WILL NOT BE OFFERED either day**
- BEST in EVENT on Sunday will be offered**

CONDITIONS OF ENTRY

- All entries must be one year or older on the day of the trial.

Stakes will be split into flights by public random draw if the entry in any regular stake is 20 or more.

- Bitches in season, lame hounds and hounds with breed disqualifications will be excused at roll call.
- Exhibitors are requested not to bring bitches known to be in season to the field
- Spayed, neutered, monorchid or cryptorchid hounds without breed disqualifications may be entered.
- Hounds with breed disqualifications are not eligible to enter except in the Single Stake.
- Hounds not present at the time of roll call will be scratched.
- All hounds will run twice, in trios if possible or braces (except in the Single Stake), unless excused, dismissed or disqualified. The members of PAHC/DASH reserve the right to alter the course plan as required by weather and/or field condition on the day of the trial.
- Each entry will be examined at inspection for breed disqualifications.

Exhibitor Information

The course will be reversed for the finals, runoffs and Best of Breed. The members of PAHC/DASH reserve the right to alter the course plan as required by weather and/or field conditions on the date of the trial. Exhibitors are requested to not bring bitches known to be in season to the field. There will be a \$5.00 fine assessed for any loose hound not participating in the course. Any person may, upon reasonable complaint, be asked to leave the grounds of the field trial by the Field Trial Committee. Bring your own shade and water. Lunch will be available for nominal fee.

Equipment: Type of lure machine: battery-powered continuous-loop system.

Type of lures: highly-visible white plastic strip. Back-up equipment will be available.

Certification: will be available on Saturday after completion of trial if weather, equipment and judges permit. Cost is \$10.00 per hound.

Practice will be offered after certifications with weather, equipment and time permitting. Cost is \$3.00 per run.

DISCLAIMER: Upon entering this trial, the exhibitor agrees to hold harmless PAHC and DASH, its members, and the event location organization (Oatlands) for any injury, loss, or damage sustained by person or hound. There will be no refund in the event that the trial has to be canceled due to weather or other

MOTEL ACCOMMODATIONS:

Red Roof Inn, 721 East Market Street, Leesburg, VA 703/777-6622,

Best Western, 726 E. Market St. Leesburg, VA, 703/777-9400

Holiday Inn, 1500 E. Market St., Leesburg, VA, 703/771-9200

Holiday Inn at Dulles, 1000 Sully Rd., Sterling, VA 703/471-7411—

12 miles from Leesburg

you'll need to verify if these hotels still honor canine guests & pet fee

Limited overnight camping (8 RVs) on the field is permitted with prior notification/ reservation to Trial Chairman Bob Jordan email: windcrest2@gmail.com cell phone 302-938-4588.

Course Plans

Saturday

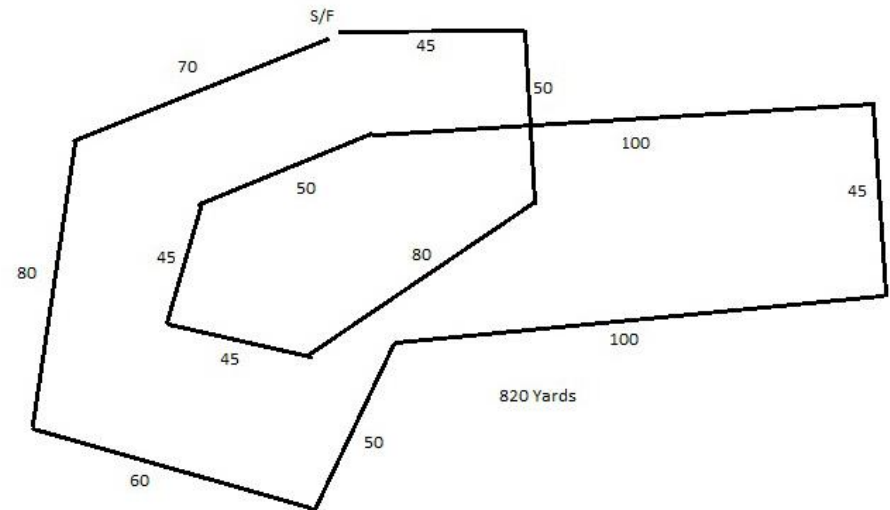

Sunday

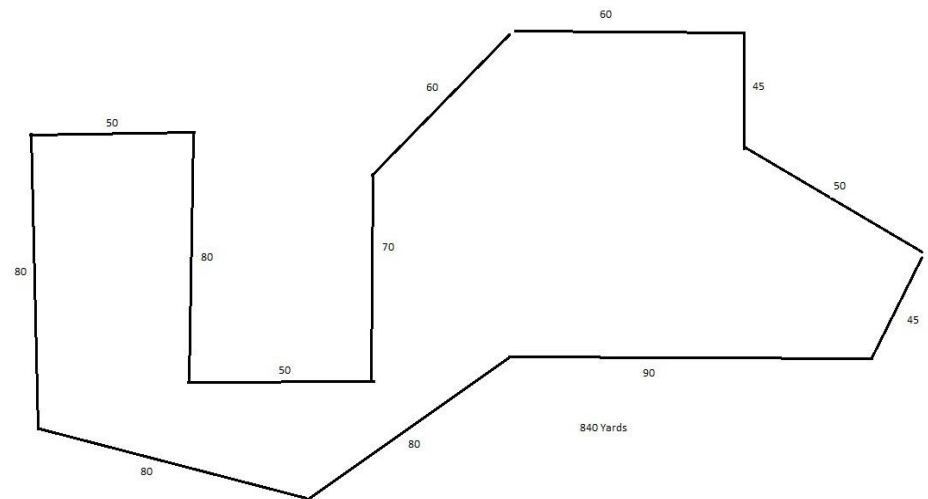

The field is fenced with typical board farm fencing.

VETERINARY CARE

TLC Emergency Clinic, 165 Ft.Evans Rd. N.E., Leesburg, VA 5; 703-777-5755. (Rt 15 bypass to Rt.7Bus.; R. on Ft. Evans to end)

Blue Ridge Veterinary Assoc.: 120 E. Cornwell Ln., Purcellville, VA; From the Rt. 7-15 bypass (& W.Market St.), go west on Rt. 7 for 6.5 miles. Take the Purcellville exit (Rt. 287) toward Purcellville and Business 7, Take immediate right onto Hirst Rd. Go approx. 1 mile & take a left onto Hatcher Ave. Take the next right onto E. Skyline Dr. to the clinic.) They are also a 24-hr. emergency service.

RIBBONS & TROPHIES:

ASFA Regional Rosettes will offered for all placement:

First=Blue

Second=Red,

Third=Yellow

Fourth=White

NBQ=Green

High Score Single=Navy/Gold

Best of Breed=Purple/Gold,

Best in Regional=Red, White & Blue

Bench, Kennel, and Breeder: pink/green

ASFA Medallions are awarded to each Best of Breed Winner

Other prizes may be offered by PAHC, DASH and friends

Go to www.ASFA.org for the latest Rulebook,
Policies, Contacts, Clubs, Trial Schedules,
Trial Results & much more

Plaques for Saturdays Best of breed Winners to honor the following Region Eight Individuals

Afghans Bob and Linda Jordan

Basenji Pete and Betty Smith

Borzoi Leigh Littleton

Greyhound Terry Fletcher

Ibizan Hound Dean Wright

Irish Wolfhound Tom Smith

Italian Greyhound Don and Nancy Ewing

Pharaoh Hound Pete and Camille Mendicino

Rhodesian Ridgebacks Ian and Carlee Davies

Salukis Peter and Carmen Day

Scottish Deerhounds Bob and Norma Sellers

Whippets Jack McManus

Regional Perpetual Trophies Best Of Breed Sunday

Afghan The Annie Trophy: Awarded to Best of Breed Afghan. Donated by Bob & Linda Jordan

Basenji: Betty & Pete Smith Trophy: Awarded to best of Breed Basenji in memory of Betty & Pete Smith

The Joey Trophy: In honor of Kenset Fire bird, LCM3 Can FCH. Donated by Jane & Pete Schreiber. (for the Basenji with the highest preliminary score, not necessarily Best of Breed)

Midnight Trophy: In honoring "Midnight" MBIF FC Thor's East of Midnight MC, LCX5, LCM6 -- Awarded to Best of Breed. Donated by Judy Brader

Borzoi: G'Kar Memorial Trophy: In commemoration of FC Silkenswift Flurry's G'Kar MC LCM2 V-FCH, CGC. Awarded to the Best of Breed Borzoi. Donated by Sally MacDowell & "Borzoi Bob" Marciszewski

In honor of Rescue Greyhounds: Donated by Mike Chang, Winston & Caroline Copeland, Evelyn Jones, Pete & Camille Mendicino, Cathey Schuchman

Quinlan Trophy: In honor of all coursing wolfhounds. Awarded to Best of Breed Irish Wolfhound. Donated by Doug Henry & Diana Vreeken

Rhodesian Ridgeback: The "Aslan" Trophy: In Loving Memory of Finny. Awarded to Best of Breed Rhodesian. Donated by Ian & Carlee Davies

Scottish Deerhound: The Sophie Trophy: In honor of CH Silver Heels of Vale Vue SC III LCM3 Region 8 Best of Breed Winner 1989 & 1990. Awarded to Best of Breed Scottish Deerhound. Donated by Ellen Bonacarti.

Whippet: Angel and Camille Trophy: In memory of FC Carbeth's Angel CD, SC LCM9 and her daughter FC Carbeth's Loud and Clear SC LCM15 XV ROMX. Awarded to **Best of Breed** Whippet. Donated by Libby & Fritz Kirchner

OFFICIAL AMERICAN SIGHTHOUND FIELD ASSOCIATION ENTRY FORM

2018 Region 8 Regional Invitational

Saturday October 27 2018

Early entries close **8pm October 24, 2018** at the FTS's residence.

Early entry fees: **\$20 for the first hound, \$18 for each additional hound**

Day of trial entry fee: **\$25 each hound**

(Substitutions, same owner, until **8am day of trial**)

Make checks payable (in US funds) to **DASH** and mail to:

Audrey Silverstein, 3620 Cemetery Ln, Westminster, MD 21158 Telephone: (410) 868-6369

Fee Paid _____ The Field Secretary cannot accept conditional, unsigned, incomplete or unpaid entries; please check your completed entry carefully.

Breed:		Call Name:	
Registered Name of Hound:			
Stake: <input type="checkbox"/> Open <input type="checkbox"/> FCH <input type="checkbox"/> Veteran <input type="checkbox"/> Single <input type="checkbox"/> Limited		Additional Stakes <input type="checkbox"/> Kennel <input type="checkbox"/> Breeder <input type="checkbox"/> Bench	
Registration Number: (please write in registering body before number)			
<input type="checkbox"/> If possible, please separate my hounds	Date of Birth:	Sex: <input type="checkbox"/> Dog <input type="checkbox"/> Bitch	
Name of actual owner(s):			
Address:		Phone:	
City:		State:	Zip:
E-mail (Optional)		(Optional) Region of Residence:	
Emergency Contact Name and Phone (Optional)			
<input type="checkbox"/> Check if this is the first ASFA trial for this hound. Attach a Hound Certification or waiver if entered in Open, Veterans, Limited.			
<input type="checkbox"/> Check if this is a first-time entry, a copy of the official Registration of this hound must accompany this entry unless NGA.			
<input type="checkbox"/> Check if any information has changed since the last ASFA trial entry. Regarding _____			
<input type="checkbox"/> Check if this hound has been dismissed within the last 6 trials entered. Must be marked in order to qualify for a "clean" trial requirement.			

I CERTIFY that I am the actual owner of this dog, or that I am the duly authorized agent of the actual owner whose name I have entered above. In consideration of the acceptance of this entry and the opportunity to have this dog judged and to win prize money, ribbons, or trophies, I (we) agree to abide by the rules and regulations of the American Sighthound Field Association in effect at the time of this lure field trial, and by any additional rules and regulations appearing in the premium list for this lure field trial. I (we) agree that the club holding this lure field trial has the right to refuse this entry for cause, which the club shall deem to be sufficient. I (we) agree to hold this club, its members, directors, governors, officers, agents or other functionaries, any employees of the aforementioned parties and the owner(s) of the trial premises or grounds harmless from any claim for loss or injury which may be alleged to have been caused directly or indirectly to any person or thing by the act of this dog while in or upon the lure field trial premises or grounds or near any entrance thereto and I (we) personally assume all responsibility and liability for any such claim, and I (we) further agree to hold the aforementioned parties harmless from any claim loss of this dog by disappearance, theft damage or injury be caused or alleged to be caused by the negligence of the club or any of the aforementioned parties or by the negligence of any person or any other cause or causes. I (we) certify and represent that the dog entered is not a hazard to person or other dogs. This entry is submitted for acceptance of the forgoing representations and agreements.

SIGNATURE of owner or his agent
duly authorized to make this entry _____

Please separate the entries before submitting to FTS.

OFFICIAL AMERICAN SIGHTHOUND FIELD ASSOCIATION ENTRY FORM

2018 Region 8 Regional Invitational

Sunday October 28, 2018

Early entries close **8pm October 24, 2018** at the FTS's residence.

Early entry fees: **\$20 for the first hound, \$18 for each additional hound**

Day of trial entry fee: **\$25 each hound**

(Substitutions, same owner, until **8am day of trial**)

Make checks payable (in US funds) to **DASH** and mail to:

Audrey Silverstein, 3620 Cemetery Ln, Westminster, MD 21158 Telephone: (410) 868-6369

Fee Paid _____ The Field Secretary cannot accept conditional, unsigned, incomplete or unpaid entries; please check your completed entry carefully.

Breed:		Call Name:	
Registered Name of Hound:			
Stake: <input type="checkbox"/> Open <input type="checkbox"/> FCH <input type="checkbox"/> Veteran <input type="checkbox"/> Single <input type="checkbox"/> Limited		Additional Stakes <input type="checkbox"/> Kennel <input type="checkbox"/> Breeder <input type="checkbox"/> Bench	
Registration Number: (please write in registering body before number)			
<input type="checkbox"/> If possible, please separate my hounds	Date of Birth:	Sex: <input type="checkbox"/> Dog <input type="checkbox"/> Bitch	
Name of actual owner(s):			
Address:		Phone:	
City:		State:	Zip:
E-mail (Optional)		(Optional) Region of Residence:	
Emergency Contact Name and Phone (Optional)			
<input type="checkbox"/> Check if this is the first ASFA trial for this hound. Attach a Hound Certification or waiver if entered in Open, Veterans, Limited.			
<input type="checkbox"/> Check if this is a first-time entry, a copy of the official Registration of this hound must accompany this entry unless NGA.			
<input type="checkbox"/> Check if any information has changed since the last ASFA trial entry. Regarding _____			
<input type="checkbox"/> Check if this hound has been dismissed within the last 6 trials entered. Must be marked in order to qualify for a "clean" trial requirement.			

I CERTIFY that I am the actual owner of this dog, or that I am the duly authorized agent of the actual owner whose name I have entered above. In consideration of the acceptance of this entry and the opportunity to have this dog judged and to win prize money, ribbons, or trophies, I (we) agree to abide by the rules and regulations of the American Sighthound Field Association in effect at the time of this lure field trial, and by any additional rules and regulations appearing in the premium list for this lure field trial. I (we) agree that the club holding this lure field trial has the right to refuse this entry for cause, which the club shall deem to be sufficient. I (we) agree to hold this club, its members, directors, governors, officers, agents or other functionaries, any employees of the aforementioned parties and the owner(s) of the trial premises or grounds harmless from any claim for loss or injury which may be alleged to have been caused directly or indirectly to any person or thing by the act of this dog while in or upon the lure field trial premises or grounds or near any entrance thereto and I (we) personally assume all responsibility and liability for any such claim, and I (we) further agree to hold the aforementioned parties harmless from any claim loss of this dog by disappearance, theft damage or injury be caused or alleged to be caused by the negligence of the club or any of the aforementioned parties or by the negligence of any person or any other cause or causes. I (we) certify and represent that the dog entered is not a hazard to person or other dogs. This entry is submitted for acceptance of the forgoing representations and agreements.

SIGNATURE of owner or his agent
duly authorized to make this entry _____

Please separate the entries before submitting to FTS

AMERICAN SIGHTHOUND FIELD ASSOCIATION
HOUD CERTIFICATION

Rule effective October 1, 1994: Ch. V, Sec. 4 (a) OPEN STAKE: To be eligible to enter the open stake, a hound must have been certified by a licensed judge within the year preceding the closing date for the entry or have previously competed in the Open Stake.

Registered Name of Hound:
Registration Number: Breed:
Registered Owner's Name:

I hereby certify that on (date) the above named hound completed a lure course of at least 500 yards, running with another hound of the same breed (or another breed with a similar running style).

Name of Licensed Judge:
Signature: Date:

I hereby certify that the hound running in the certification course is the hound identified above and that information provided on this form is true and correct.

Signature: Date:

Owner or Authorized Agent of Hound

This certification form must be attached to the entry form the first time this hound is entered in an open, limited, or veteran stake. Any hound entered in open, limited, or veteran (as a first time entered hound), which has not been certified, shall be declared ineligible by the records coordinator and shall forfeit any points and placements awarded.

PLEASE RETAIN A COPY FOR YOUR RECORDS.

AMERICAN SIGHTHOUND FIELD ASSOCIATION
HOUD CERTIFICATION WAIVER

Waiver of Requirement: This requirement will be waived for a hound that has earned a lure coursing or racing title from another recognized organization, if such title requires competition, and if a waiver for such title has been approved by the ASFA, or a CKC Hound Certification Form.

Registered Name of Hound:
Registration Number: Breed:
Registered Owner's Name:

Table with columns for abbreviations (CKC, AKC, WRA) and breeds (FCH, QC, CR, FCHX, SC, WRCH, ARX, GRC, ORC, TRP, OTR, SRA, RCH, SORC, DPC, SR, SOR).

Hound Certification previously submitted.

I hereby certify that the hound identified above has completed the requirements for the title indicated above (or that the required Certification was previously submitted) and that the information provided on this form is true and correct.

Signature: Date:
Owner or Authorized Agent of Hound

AMERICAN SIGHTHOUND FIELD ASSOCIATION
HOUD CERTIFICATION

Rule effective October 1, 1994: Ch. V, Sec. 4 (a) OPEN STAKE: To be eligible to enter the open stake, a hound must have been certified by a licensed judge within the year preceding the closing date for the entry or have previously competed in the Open Stake.

Registered Name of Hound:
Registration Number: Breed:
Registered Owner's Name:

I hereby certify that on (date) the above named hound completed a lure course of at least 500 yards, running with another hound of the same breed (or another breed with a similar running style).

Name of Licensed Judge:
Signature: Date:

I hereby certify that the hound running in the certification course is the hound identified above and that information provided on this form is true and correct.

Signature: Date:

Owner or Authorized Agent of Hound

This certification form must be attached to the entry form the first time this hound is entered in an open, limited, or veteran stake. Any hound entered in open, limited, or veteran (as a first time entered hound), which has not been certified, shall be declared ineligible by the records coordinator and shall forfeit any points and placements awarded.

PLEASE RETAIN A COPY FOR YOUR RECORDS.

AMERICAN SIGHTHOUND FIELD ASSOCIATION
HOUD CERTIFICATION WAIVER

Waiver of Requirement: This requirement will be waived for a hound that has earned a lure coursing or racing title from another recognized organization, if such title requires competition, and if a waiver for such title has been approved by the ASFA, or a CKC Hound Certification Form.

Registered Name of Hound:
Registration Number: Breed:
Registered Owner's Name:

Table with columns for abbreviations (CKC, AKC, WRA) and breeds (FCH, QC, CR, FCHX, SC, WRCH, ARX, GRC, ORC, TRP, OTR, SRA, RCH, SORC, DPC, SR, SOR).

Hound Certification previously submitted.

I hereby certify that the hound identified above has completed the requirements for the title indicated above (or that the required Certification was previously submitted) and that the information provided on this form is true and correct.

Signature: Date:
Owner or Authorized Agent of Hound

Kennel & Breeder Stake Entry

One form per pair of hounds per Stake

Check one or both: Kennel Stake Breeder Stake Bench Stake

Check one or both: Saturday Sunday

Breed: _____

Breeder(s): _____

Hound #1

Call Name: _____

Registered Name: _____

Owner(s): _____

Hound #2:

Call Name: _____

Registered Name: _____

Owner(s): _____

Please include \$5 per pair of hounds for EACH non-reg

Kennel & Breeder Stake Entry

One form per pair of hounds per Stake

Check one or both: Kennel Stake Breeder Stake Bench Stake

Check one or both: Saturday Sunday

Breed: _____

Breeder(s): _____

Hound #1

Call Name: _____

Registered Name: _____

Owner(s): _____

Hound #2:

Call Name: _____

Registered Name: _____

Owner(s): _____

Please include \$5 per pair of hounds for EACH non-reg

Kennel & Breeder Stake Entry

One form per pair of hounds per Stake

Check one or both: Kennel Stake Breeder Stake Bench Stake

Check one or both: Saturday Sunday

Breed: _____

Breeder(s): _____

Hound #1

Call Name: _____

Registered Name: _____

Owner(s): _____

Hound #2:

Call Name: _____

Registered Name: _____

Owner(s): _____

Please include \$5 per pair of hounds for EACH non-reg

Kennel & Breeder Stake Entry

One form per pair of hounds per Stake

Check one or both: Kennel Stake Breeder Stake Bench Stake

Check one or both: Saturday Sunday

Breed: _____

Breeder(s): _____

Hound #1

Call Name: _____

Registered Name: _____

Owner(s): _____

Hound #2:

Call Name: _____

Registered Name: _____

Owner(s): _____

Please include \$5 per pair of hounds for EACH non-reg

The Regional Dinner will be at lunch on Saturday

The menu will be:

Fried Chicken

Baked Beans

Cole Slaw

Potato Salad

Rolls

Dessert

Soft Drinks

The Cost will be \$7.00

Comments and awards by

ASFA President

Dean Wright



Potomac Afghan Hound Club



District Area Sighthound